



| PLOT AREA IN RESIDENTIAL                                       |            | 45608.07  |              |       |    |                  |
|--|------------|-----------|--------------|-------|----|------------------|
| GROUND COVERAGE  |            | 11084.89  |              |       |    |                  |
| SOFT LANDSCAPE GREEN REQUIRED IN RESIDENTIAL @25% OF PLOT AREA |            | 11402.055 |              |       |    |                  |
| SOFT LANDSCAPE PROPOSED IN RESIDENTIAL AREA (S)                |            |           |              |       |    |                  |
| SYMBOL   | A          | B         | AREA (sq.m.) |       |    |                  |
| V1   | FROM PLINE | -         | 4597.940     |       |    |                  |
| V2   | FROM PLINE | -         | 685.490      |       |    |                  |
| V3   | FROM PLINE | -         | 51.200       |       |    |                  |
| V4   | FROM PLINE | -         | 463.040      |       |    |                  |
| V5   | FROM PLINE | -         | 2374.510     |       |    |                  |
| V6   | FROM PLINE | -         | 2270.190     |       |    |                  |
| V7   | FROM PLINE | -         | 1148.330     |       |    |                  |
| V8   | FROM PLINE | -         | 1352.380     |       |    |                  |
| V9   | RECTANGLE  | 71.998    | 5.398        | A x B | 1  | 388.645          |
| V10  | RECTANGLE  | 4.348     | 8.968        | A x B | 4  | 155.971          |
| V10a   | RECTANGLE  | 4.4       | 9.188        | A x B | 5  | 202.136          |
| V11  | FROM PLINE | -         | 322.250      |       |    |                  |
| V12  | CIRCLE     | -         | -            | -     | 2  | 88.340           |
| V13  | RECTANGLE  | 6.007     | 46.259       | A x B | 1  | 277.878          |
| V14  | RECTANGLE  | 7.3       | 2.4          | A x B | 4  | 70.080           |
| V15  | RECTANGLE  | 7.3       | 1.029        | A x B | 1  | 7.512            |
| V16  | RECTANGLE  | 7.3       | 5.42         | A x B | 1  | 39.566           |
| V17  | FROM PLINE | -         | 314.660      |       |    |                  |
| V18  | RECTANGLE  | 5.391     | 2.4          | A x B | 2  | 25.877           |
| V19  | FROM PLINE | 7.313     | 2.302        | A x B | 1  | 16.835           |
| V20  | RECTANGLE  | 7.308     | 3.792        | A x B | 1  | 27.712           |
| V21  | RECTANGLE  | 9.54      | 3            | A x B | 3  | 85.860           |
| V22  | RECTANGLE  | 2.88      | 2.88         | A x B | 1  | 8.294            |
| V23  | RECTANGLE  | 3         | 9.584        | A x B | 1  | 28.752           |
| V24  | RECTANGLE  | 2.998     | 9.647        | A x B | 1  | 28.922           |
| V25  | RECTANGLE  | 2.997     | 9.595        | A x B | 1  | 28.556           |
| V26  | RECTANGLE  | 7.5       | 99.802       | A x B | 1  | 748.515          |
| V27  | RECTANGLE  | 7.291     | 4.401        | A x B | 10 | 320.877          |
| V28  | RECTANGLE  | 5.277     | 9.545        | A x B | 5  | 249.459          |
| V29  | RECTANGLE  | 7.291     | 6.2          | A x B | 1  | 45.204           |
| V30  | RECTANGLE  | 6.806     | 2.77         | A x B | 1  | 18.853           |
| V31  | FROM PLINE | -         | -            | -     | -  | 107.760          |
| <b>Total</b>   |            |           |              |       |    | <b>16551.784</b> |

| DEDUCTIONS IN SOFT LANDSCAPE (D)           |            |       |       |       |   |                  |
|--|------------|-------|-------|-------|---|------------------|
| V11'                                       | RECTANGLE  | 6.8   | 5.7   | A x B | 1 | 38.760           |
| V10'                                       | RECTANGLE  | 2.1   | 8.968 | A x B | 1 | 18.833           |
| FIRE ESCAPES                               | RECTANGLE  | 3.61  | 6.81  | A x B | 7 | 181.623          |
| <b>TOTAL</b>                               |            |       |       |       |   | <b>239.216</b>   |
| ADDITIONS FOR SOFT LANDSCAPE (A)           |            |       |       |       |   |                  |
| V32  | RECTANGLE  | 2.55  | 9.54  | A x B | 1 | 24.327           |
| V33  | RECTANGLE  | 2.63  | 9.54  | A x B | 1 | 25.090           |
| V34  | RECTANGLE  | 2.827 | 9.54  | A x B | 1 | 26.970           |
| V35  | FROM PLINE | -     | -     | -     | - | 23.529           |
| V36  | RECTANGLE  | 2.45  | 9.54  | A x B | 1 | 23.373           |
| V37  | RECTANGLE  | 2.555 | 9.355 | A x B | 1 | 23.902           |
| V38  | RECTANGLE  | 2.7   | 8.272 | A x B | 1 | 22.334           |
| V39  | RECTANGLE  | 3.482 | 9.057 | A x B | 1 | 31.538           |
| V40  | RECTANGLE  | 3.692 | 9.54  | A x B | 1 | 35.223           |
| V41  | FROM PLINE | -     | -     | -     | - | 21.042           |
| V42  | FROM PLINE | -     | -     | -     | - | 930.006          |
|  |            |       |       | A=    |   | 1187.431         |
| <b>NET SOFT LANDSCAPE PROVIDED = S-D+A</b> |            |       |       |       |   | <b>17500.000</b> |

|   |           |
|---|-----------|
| REQUIRED SOFT LANDSCAPE AREA, I.e., 50% OF OPEN AREA = (PLOT AREA-GROUND COVERAGE)*0.50 | 17261.590 |
| PROPOSED SOFT LAND AREA   | 17500.000 |
| REQUIRED NUMBER OF TREES  | 346       |
| PROPOSED NUMBER OF TREES  | 430       |

| EARTH ICONIC INFRASTRUCTURES PVT. LTD. |               |                      |               |                 |                 |
|--|---------------|----------------------|---------------|-----------------|-----------------|
| AREA CALCULATION                       |               |                      |               |                 |                 |
| PROPOSED RESIDENTIAL DEVELOPMENT       |               | ACHIEVED AS/MP (sqm) |               | PROPOSED (sqm)  |                 |
| PERMISSIBLE (sqm)                      | TOWER + VILLA | TOTAL RESI PLOT      | TOWER + VILLA | TOTAL RESI PLOT | TOTAL RESI PLOT |
| TOTAL SITE AREA                        | 45,608.070    |                      |               |                 |                 |
| GROUND COVERAGE 30%                    | 13,682.421    | 11,304.180           |               | 11,111.497      |                 |
| F.A.R. @ 1.75                          | 79,814.123    | 75,831.010           | 77,331.000    | 75,649.481      | 74,304.045      |

| PARKING REQUIREMENTS  |            |                |            |
|---|------------|----------------|------------|
| REQUIREMENT   | FAR AREA   | NO. OF PARKING | SAY        |
| Parking Required for Residential Building @ 1 EC's per 112 sqm of FAR | 79,814.123 | 712.626        | 713        |
| PARKING PROVIDED  |            |                | 69         |
| VISITOR PARKING (OPEN AS/MP)  |            |                | 713        |
| BASEMENT PARKING  |            |                |            |
| <b>TOTAL PARKING PROVIDED</b>   |            |                | <b>802</b> |

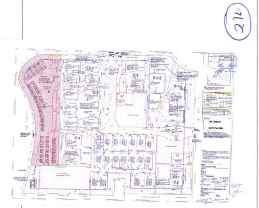
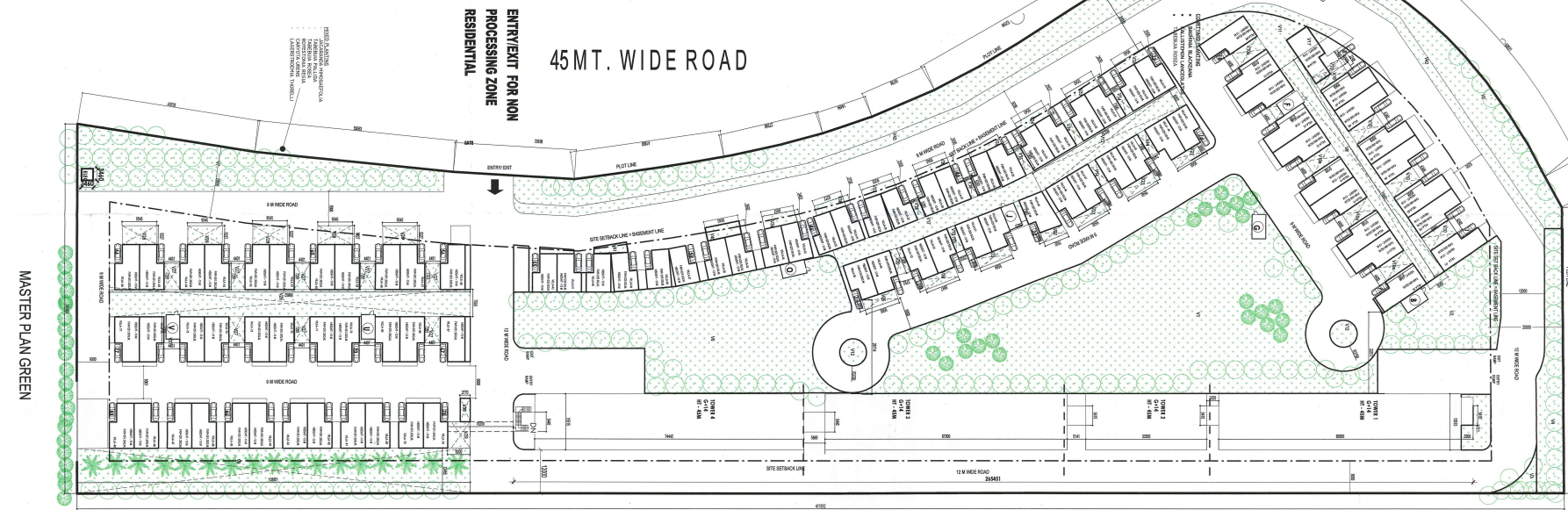

Client/Co-Developer  
**EARTH ICONIC INFRASTRUCTURES PVT. LTD.**  
 Developer  
**ANSAL IT CITY & PARK LTD**

**Bios** ARCHITECTURE  
 B1, 11th Floor, Hazratganj East, New Delhi 110 013  
 Phone: 011 26359041  
 Fax: 011 26359042  
 Email: bios@biosarchitecture.com

Disclaimer  
 Drawings and written material appearing herein constitute original and confidential work of the Architect and may not be duplicated, used or disclosed without written consent of the Architect.

Drawing Status

**SUBMISSION DRAWING**

Architect's Signature: **SVYED MOHID, MURAH**  
 Director/Arch. Sign.  
 Client's Signature: **BRJ KUMAR SRIVASTAVA**  
 M. PLANNING  
 AITP-2010-127

Key Plan  
 Approved by:  
**BRJ KUMAR SRIVASTAVA**  
 M. PLANNING  
 AITP-2010-127

Project Name  
**PROPOSED RESIDENTIAL DEVELOPMENT**

Project Address: **Phase 2, Sector 15, Gurgaon, Haryana**  
 Proposed by: **ANSAL IT CITY & PARK LTD**  
 Approved by: **Dr. Gen. Mansur**  
 (Planner)  
 Approved by: **Dr. Gen. Mansur**  
 (Planner)  
 Approved by: **Dr. Gen. Mansur**  
 (Planner)

Project No.: **13.16 MPR**  
 Scale: **1:600**  
 Date: **September 30, 2013**

Drawing No: **A101** Revision: **RO**